

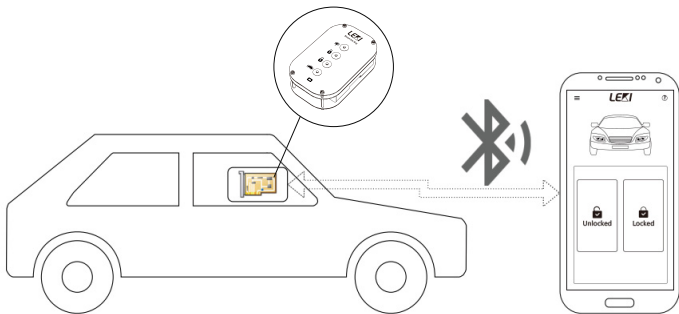

Leki Smart Car Key User Manual



Product Description

As long as you carry a phone, you can lock/unlock your car, find your car and more!

With Leki Smart Car Key, say goodbye to fumbling with car keys or worrying about losing them!

Simply solder and assemble the Leki Receiver to the circuit board of your original car key and place it in your car. Then with a simple setup on the Leki App, your phone will turn into your car key instead!

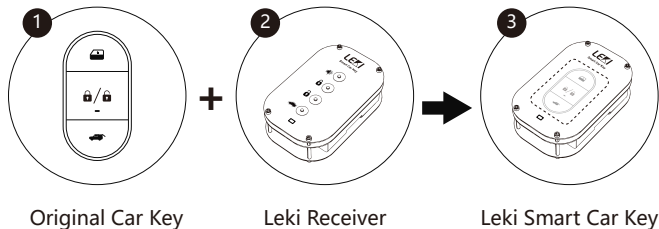

Package List



Leki Receiver x1



Hexagonal
Screwdriver x1

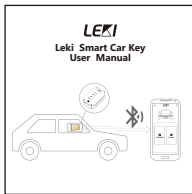

User Manual x1

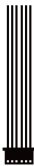

Soldering Jumper
Wire x1

Basic Parameters

Dimension (L x W x H)	90mm x 55mm x 20mm
Weight	49g
Battery Type	2 * AAA Batteries
Battery Life	5 Months (Connect 2 Hours per Day)
Communication Protocol	Bluetooth 4.2
Working Mode	Manual Control & App Control
Working Range	< 100ft (No Obstacles)

Leki Receiver

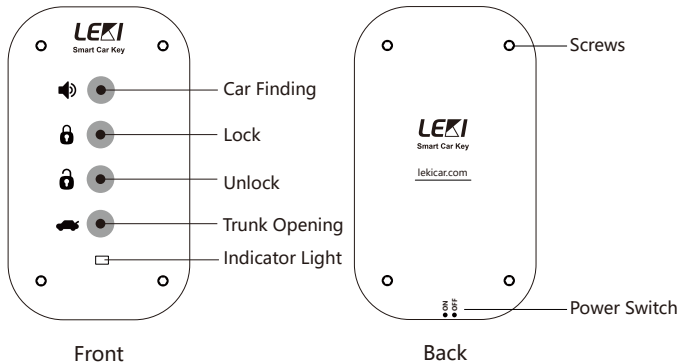

Tips: The assembled Leki Receiver can be controlled directly by the physical button (as the figure above). Press the button and the indicator light will flash once.

Setup Overview

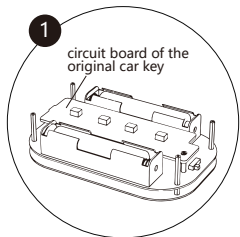

Step 1: Assemble the circuit board of your original car key into the Leki Receiver

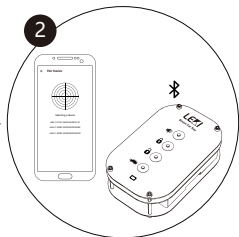

Step 2: Device binding

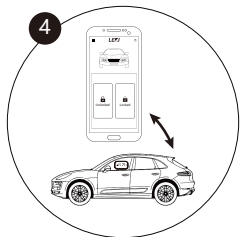

Step 4: Lock/Unlock your car with just your phone

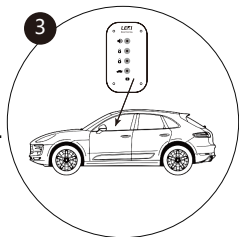

Step 3: Put the Leki Smart Car Key in the car

Assembling the Leki Receiver

There are certain soldering skills required to assemble the Leki Receiver. We recommend that you seek assistance from a professional (e.g., car repair shop) to complete the assembly. Additionally, it is important to create a backup of the original car key beforehand to prevent damage that may be caused by improper handling.

(1) Take out the circuit board of the original key, It is recommended to search on the internet to find out how to remove the original key circuit board or consult with relevant professionals (e.g., car repair shop).

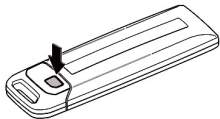

Press the release button
of the original key

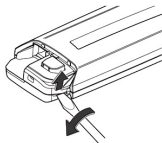

Gently pry open the key with
a flathead screwdriver

Note: The figure above is a reference to individual car models of keys, not all models of disassembled keys operate in this way.

(2) Assemble the circuit board of the original key into the Leki Receiver.

Please scan the QR code below for the soldering tutorial.



Connection Instructions of Soldering Jumper Wire

Red Wire	Connects Positive (Usually DC 3.0V)
Black Wire	Connects Negative (A.k.a. Ground or GND)
Yellow Wire	Connects to the pin/pad of the Unlock Button
Green Wire	Connects to the pin/pad of the Lock Button
Blue Wire	Connects to the pin/pad of the Car Finding Button
White Wire	Connects to the pin/pad of the Trunk Opening Button

Note: If your original car key does not have a car finder/trunk control function, please cut the corresponding wire to prevent the excess wire from shorting out.

Device Binding

(1) Search "Leki" on Google Play/App Store or scan the QR Code below to download the Leki App.



Download on the
App Store



Get it on
Google Play



Android

(2) Please scan the QR code below for the setup tutorial.



(3) Turn on the Bluetooth, for Android, please also enable GPS and agree to grant location permission.



(4) Click "Go to Pairing" on the home page, and then select "Add Device".

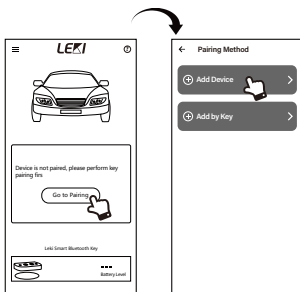

(5) Turn the power switch to ON to power on the Device.

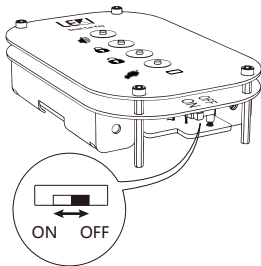

(6) Press and hold the "Lock Button" and "Unlock Button" on the Device for 5 seconds until the indicator light turns orange and stays on, and then click "Next Step" on the App.

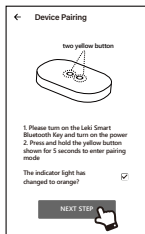
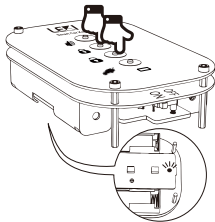

(7) Select the Device to be paired.

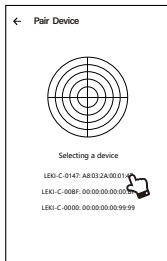

(8) After the pairing is completed, the App will automatically generate a device key code and device key QR code, please take a screenshot and save it.

When you use another phone to bind the existing Leki Smart Car Key, you can directly enter the device key code to set up the binding without re-setting up.



(9) Then place the Leki Smart Car Key inside the vehicle. We recommend placing it in the vehicle's storage box/center console (Avoid being exposed under direct sunlight and high temperature environment).

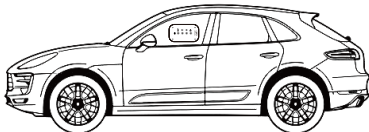

General Function

You can lock/unlock your car's door via Bluetooth on your phone only if you are within 100ft of it and the Bluetooth and Leki App are turned on. The Leki Receiver will automatically connect to the App via Bluetooth, allowing you to lock/unlock your vehicle through the Leki App.

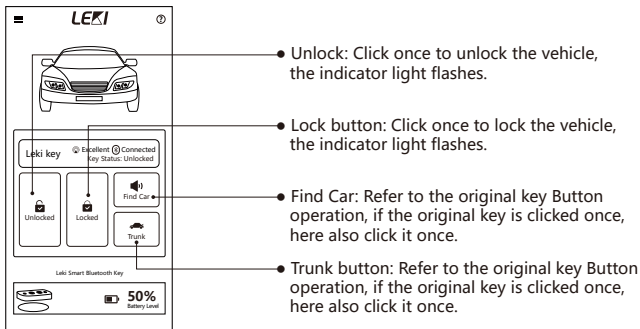

Tips: The Leki Smart Car Key is in a modification based on the original car key, so it supports the same functions as the original car key. If your original car key does not support "Car Finding" or "Trunk Opening", the Leki Smart Car Key will not be able to achieve this function either. Please check the function of your original car key before use.

Precautions for Use

- This product should not be put into the fire, it will have the risk of explosion.
- The product should not be exposed to the sun for a long time.
- This product should not be immersed in water.

FAQ

Q : What should I do if the Leki Smart Car Key fails to work?

A : The Leki Smart Car Key communicates with the App via Bluetooth and is not affected by the network signal. As long as the Leki Smart Car Key is on and within the range of Bluetooth, it will work.

Q : Why the App can't lock the car?

A : This is most likely due to the fact that you have two original keys in your car. Please check the car to make sure there are no original keys other than Leki Smart Car Key.

There is also a case of low battery power, it is recommended to replace the battery in time when the battery power is below 25%.

Q : Can Leki Smart Car Key work in underground garages and other places where there is no network signal?

A : The Leki Smart Car Key communicates with the App via Bluetooth and is not affected by the network signal. As long as the Leki Smart Car Key is on and within the range of Bluetooth, it will work.

Q : The Leki App cannot connect to the Leki Smart Car Key after the phone is restarted.

A : It might be that the Bluetooth status of the Leki Smart Car Key has changed after the phone has been rebooted. Please bind your device to your Leki account again via the Leki App (Refer to Page 6, Device Binding).

Q : Where should I put the Leki Smart Car Key in my car?

A : We recommend that priority be given to securing the Leki Smart Key to the sun visor or dashboard to ensure stable signal reception for unlocking/locking. If the above locations are not suitable, please consider placing the device in the center console or the armrest box. Please note that if the Leki Smart Key is obscured, it may cause

unlocking/locking to fail. Therefore, please test the device promptly after installation to ensure proper use.

Q : Why does the button of Leki App show that it is operable, but when I click the button, it keeps showing "Sending Command", "Sending Unsuccessful"?

A : The connection between the App and Leki Smart Car Key may have been disconnected and there is a delay on the App, please exit the App and reopen it, and connect Leki Smart Car Key again.

Customer Service

 +1 (530) 988-8608

 <https://lekicar.com/>

For more features of Leki, please visit the official website

